

Explore Genetic Technology to  
Improve the Quality of Life

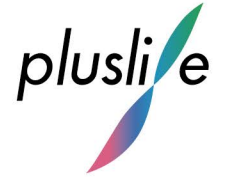

# Pluslife

## Product Catalog for Pet Diagnosis

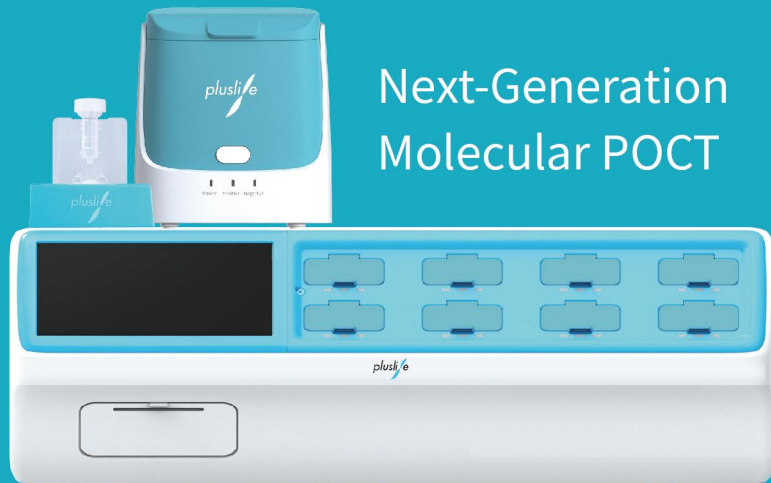

Next-Generation  
Molecular POCT



# Pluslife Pet Diagnosis

## < Rapid >

Onsite result in **7-35 mins**

## < Accurate >

Comparable to **PCR**

## < Simple >

**1-2 mins** hands-on time

## < Powerful >

Up to **4 pathogens** in 1 test

**Pluslife Pet Diagnosis**

**Next-Generation Molecular POCT**

# Mini Dock

## Rapid Molecular POCT System

PM003



## Features

- Palm-sized, weighing less than iPhone 14 (-240g)
- Free from cold-chain
- Results displayed via Indicator/APP/PC
- Support LIS system
- Compatible with Smart Charging Station

## Application Scenarios



Hospital/Clinic



Pet Shop



Testing Center

## Test Procedure



Collect Sample

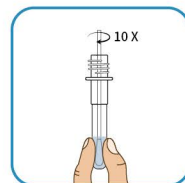

Mix Sample

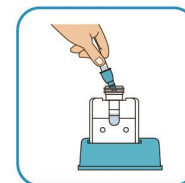

Prepare Reaction Card



Run Test

# Dock Pro 8

Eight-Channel POC Molecular Analyzer

PM008P



## Features

- 8 test channels work independently
- Free from cold-chain
- Benchtop size and stackable
- 7" touchscreen with intuitive control
- Support LIS system
- Barcode reader and result printing

## Application Scenarios



Hospital/Clinic



Pet Shop



Testing Center

## Test Procedure



Collect Sample

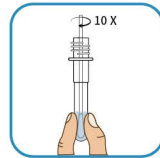

Mix Sample

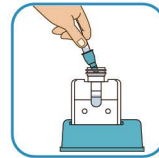

Prepare Reaction Card



Scan Sample

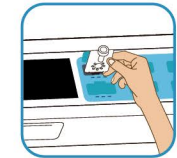

Run Test



# I Test Menu

## Feline Infectious Diseases

- FHV-1/C.felis/M.felis
- Feline calicivirus(FCV) \*
- Feline immunodeficiency virus/Feline leukemia virus (FIV/FeLV) \*

## Canine Infectious Diseases

- CDV/CPIV/CAV-2/Bb
- Canine coronavirus(CCoV) \*
- Babesia/Ehrlichia/Anaplasma/Leishmania \*

## Feline/Canine Infectious Diseases

- Giardia \*
- Parvovirus(CPV/FPV) \*

\* In development





## FHV-1/C.felis/M.felis

### Nucleic Acid Test Card

**Specimen type:** eye swab, nasal swab or oropharyngeal swab  
**LoD:** 1000 copies/mL  
**Multi-pathogen detection:** up to 3 pathogens in 1 test  
**Hands-on time:** within 1-2 mins

A comparison study was performed between Pluslife and PCR

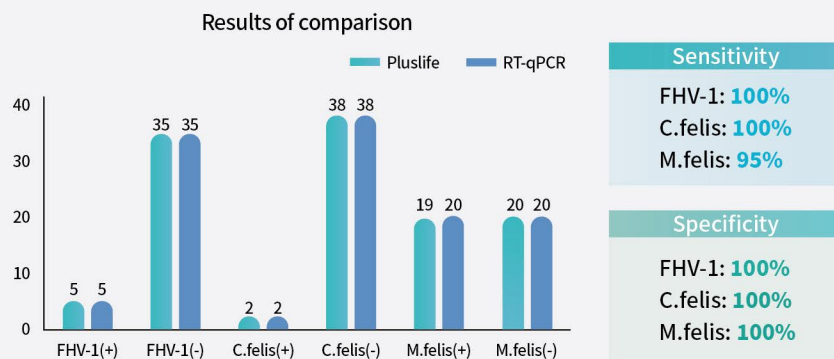

Source: Pet clinic (China)



## CDV/CPIV/CAV-2/Bb

### Nucleic Acid Test Card

**Specimen type:** eye swab, nasal swab or oropharyngeal swab  
**LoD:** 1000 copies/mL  
**Multi-pathogen detection:** up to 4 pathogens in 1 test  
**Hands-on time:** within 1-2 mins

A comparison study was performed between Pluslife and PCR

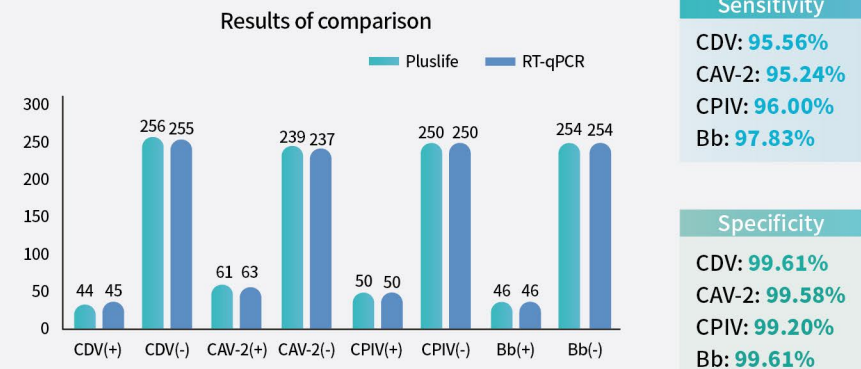

Source: Pet clinic (China)





# FCV

## Nucleic Acid Test Card

**Specimen type:** eye swab, nasal swab or oropharyngeal swab

**LoD:** 1000 copies/mL

**Hands-on time:** within 1-2 mins



# CPV/FPV

## Nucleic Acid Test Card

**Specimen type:** rectal swab

**LoD:** 1000 copies/mL

**Hands-on time:** within 1-2 mins



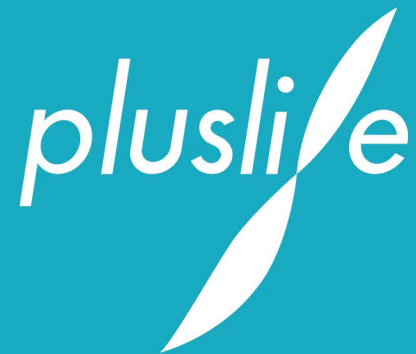

## Guangzhou Pluslife Biotech Co.,Ltd.

 +86-020-31703986

 market@pluslife.com

 www.pluslife.com

 Floor 3, Block E, Runhui Science & Technology Park, No.18 Shenzhou RD, Huangpu District, Guangzhou, Guangdong, China



Website



LinkedIn

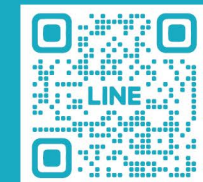

Line